

STAMP JOB # FROM TRAVELER
IN AREA UNDER ADJUSTMENT
SCREWS AND CENTERED

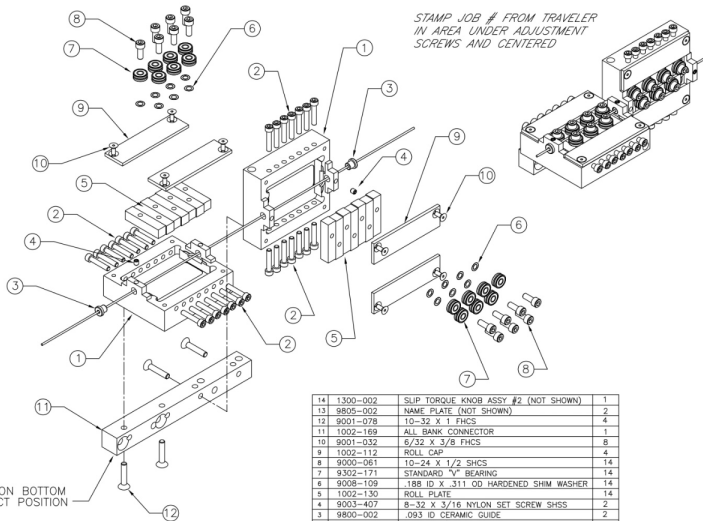

14	1300-002	SLIP TORQUE KNOB ASSY #2 (NOT SHOWN)	1
13	9805-002	NAME PLATE (NOT SHOWN)	2
12	9001-078	10-32 X 1 FHCS	4
11	1002-189	ALL BANK CONNECTOR	1
10	9001-032	6/32 X 3/8 FHCS	8
9	1002-112	ROLL CAP	4
8	9000-061	10-24 X 1/2 SHCS	14
7	9302-171	STANDARD "V" BEARING	14
6	9008-109	.188 ID X .311 OD HARDENED SHIM WASHER	14
5	1002-330	ROLL PLATE	14
4	9003-407	8-32 X 3/16 NYLON SET SCREW SHSS	2
3	9800-002	.093 ID CERAMIC GLIDE	2
2	9000-052	8-32 X 7/8 SHCS	28
1	1002-111	UNIBODY HOUSING #2	2
ITEM	PART NUMBER	DESCRIPTION	QTY

REV	ENGR	CHK BY	DATE

NOVO
PRECISION

TOLERANCE UNLESS OTHERWISE STATED
 .125 ± .0005
 .0625 ± .0005
 .03125 ± .0005
 .015625 ± .0005

QAD

OWN: KPL

CHK:

SCALE

DATE 3/28/02

DRAWING / PART NO.
1002-002

PART NAME:
1002 2 PLANE
EXPLODED ASSY
CUSTOMER