

STAMP JOB # FROM TRAVELER
IN AREA UNDER ADJUSTMENT
SCREWS AND CENTERED

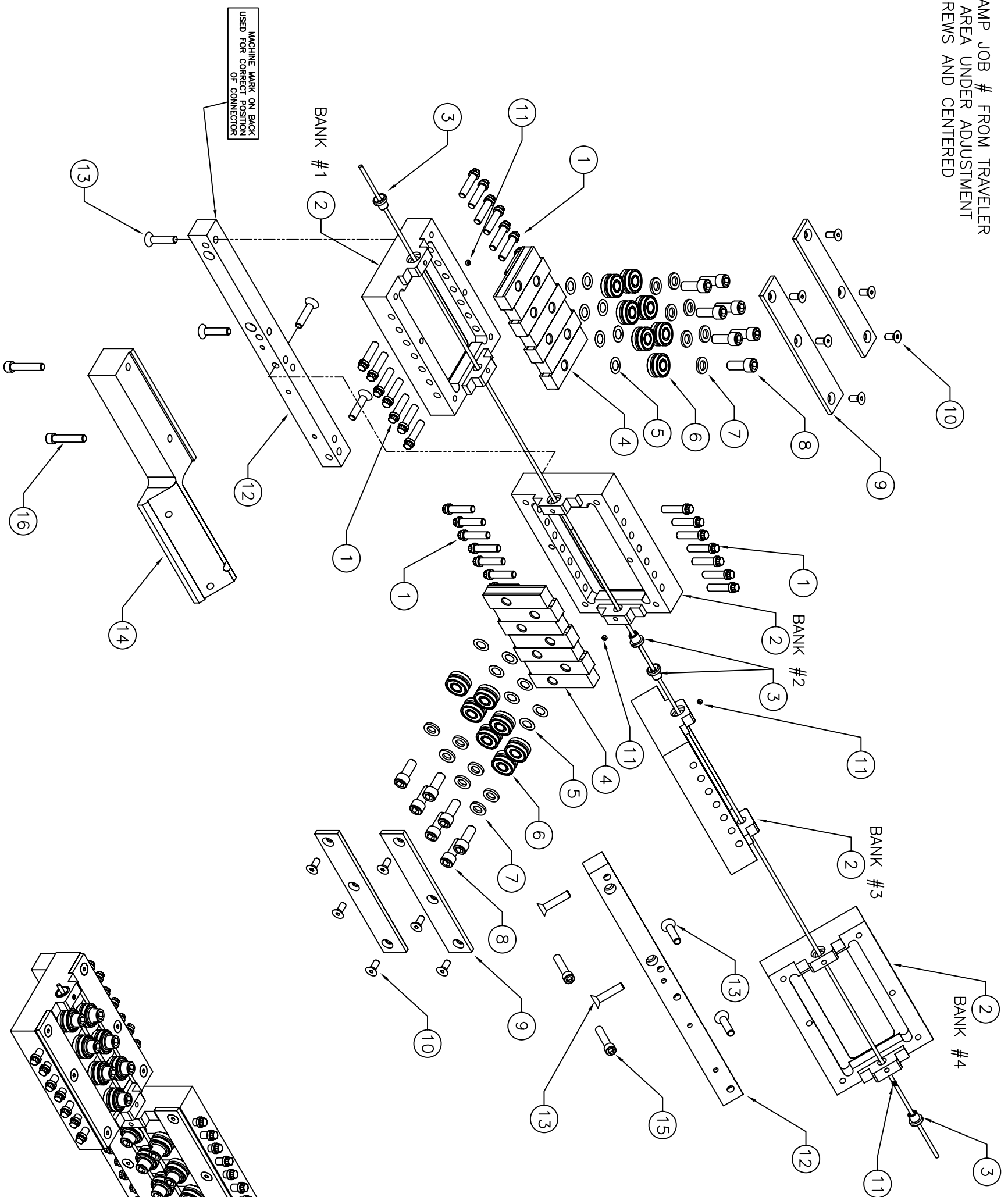

ITEM	QTY	PART #	DESCRIPTION
17	1	1300-004	TORQUE WRENCH (NOT SHOWN)
16	2	9000-150	3/8-16 X 2 SHCS
15	2	9000-152	3/8-16 X 2-1/2 SHCS
14	1	1004-205	#4 PLANE ADAPTOR CONNECTOR
13	8	9001-149	3/8-16 X 1-3/4 FHCS
12	2	1004-203	#4 UNIVERSAL CONNECTOR
11	4	9003-425	1/4-28 X 3/16 SHSS NYLON TIP (INV.)
10	24	9001-118	5/16-18 X 3/4 FHCS
9	8	1004-202	#4 ROLL CAP
8	28	900M-070	12MM X 1.75 X 30MM METRIC SHCS
7	28	9008-117	WASHERS (INV.)
6	28	9304-166	#4 WIDE "V" BEARING
5	28	9008-118	SHIM WASHER
4	28	1004-201	#4 UNIBODY ROLL PLATE
3	4	9800-012	CERAMIC WIRE GUIDE
2	4	1004-200	#4 UNIBODY HOUSING
1	56	9004-201	3/8-16 X 1-1/2 HEX HEAD 12 PT SCREW

NOTE:
3 & 4 BANK ASSY'S SAME AS 1 & 2 BANK ASSY.
THEN ROTATED 45° TO INSTALL ON P/N 1004-205
4 PLANE CONNECTOR -- #14

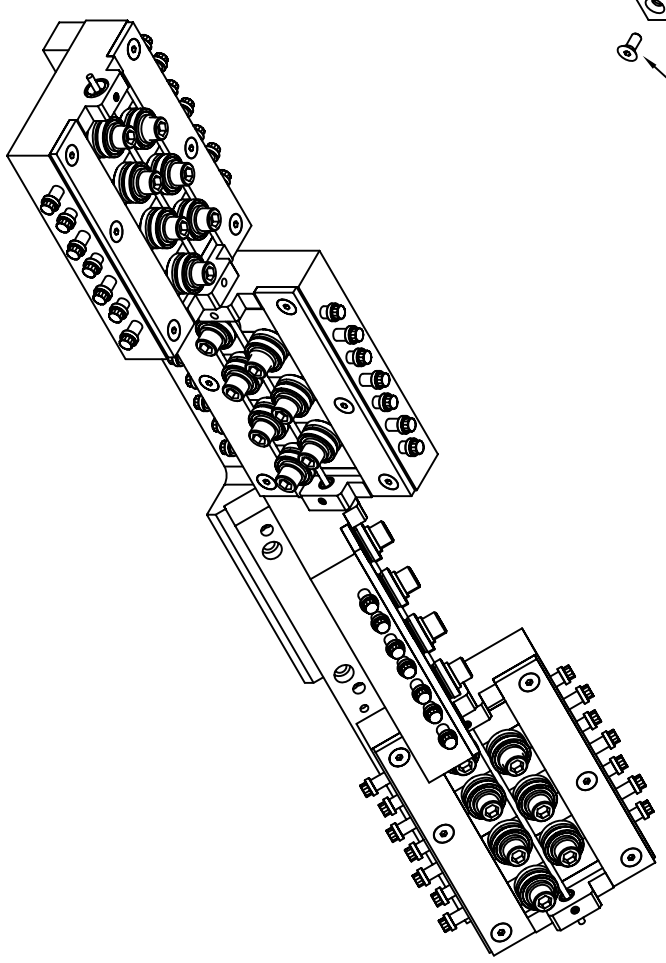

MACHINE MARK ON BACK
USED FOR CORRECT POSITION
OF CONNECTOR

SERIES #04 UNIBODY 4 PLANE PWS ASSY.



REV	ECN	CHG BY	DATE

TOLERANCE UNLESS OTHERWISE STATED	CAD	DRAWING / PART NO.
± .3	DWN	1004-014
± 0.0003	RPL	PART NAME
± 0.0002		#4 PWS ASSY.
± 0.0005		CUSTOMER
± 0.0005		EXPLODED VIEW

DATE 4/2/02

MATERIAL REQ'D. R.C.