

STAMP JOB # FROM TRAVELER  
IN AREA UNDER ADJUSTMENT  
SCREWS AND CENTERED

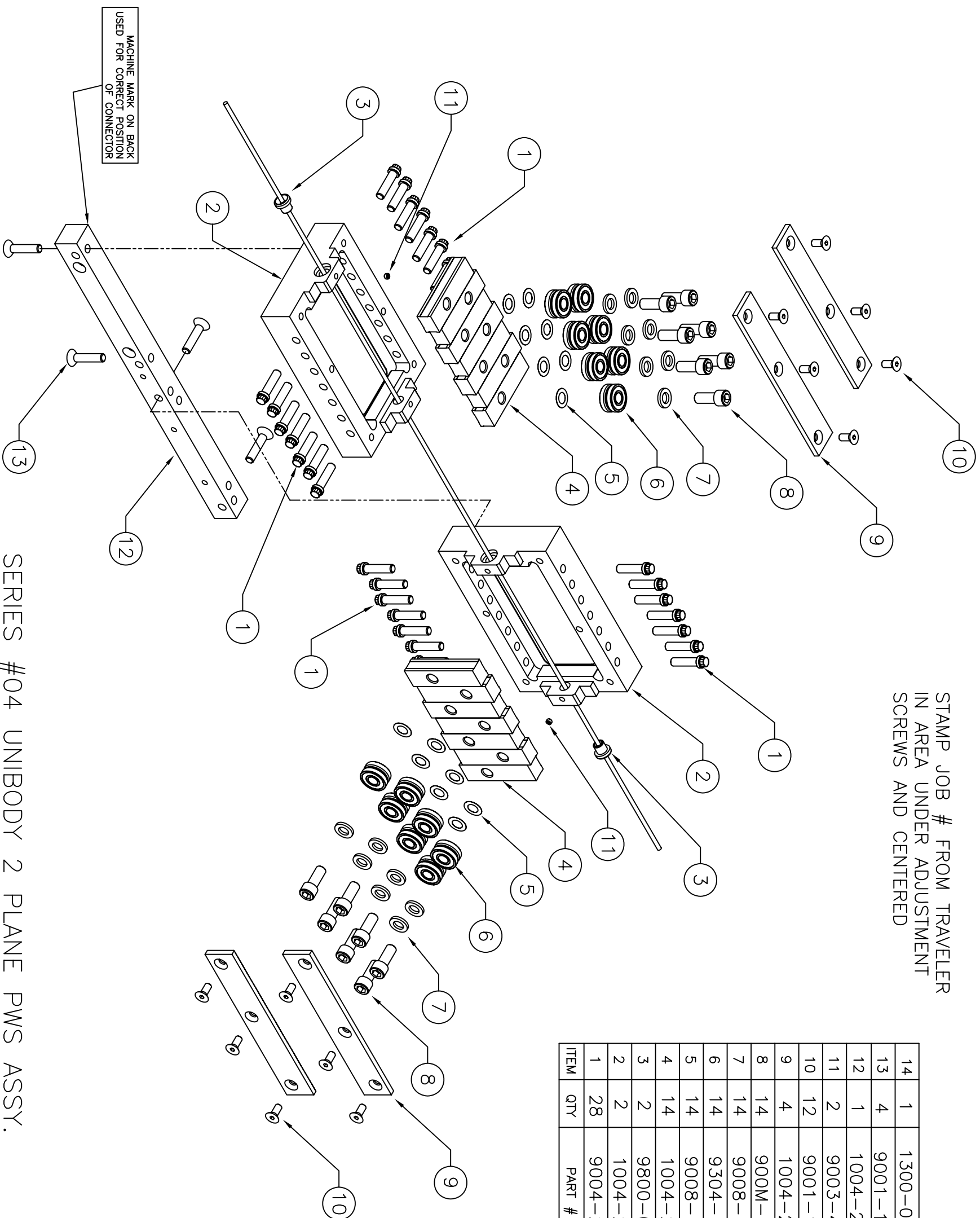

SERIES #04 UNIBODY 2 PLANE PWS ASSY.

ITEM	QTY	PART #	DESCRIPTION
14	1	1300-004	TORQUE WRENCH (NOT SHOWN)
13	4	9001-149	3/8-16 X 1-3/4 FHCS
12	1	1004-203	#4 UNIVERSAL CONNECTOR
11	2	9003-425	1/4-28 X 3/16 SHSS NYLON TIP (INV)
10	12	9001-118	5/16-18 X 3/4 FHCS
9	4	1004-202	#4 ROLL CAP
8	14	900M-070	12MM X 1.75 X 30MM METRIC SHCS
7	14	9008-117	WASHERS
6	14	9304-166	#4 WIDE "V" BEARING
5	14	9008-118	SHIM WASHER (INV)
4	14	1004-201	#4 UNIBODY ROLL PLATE
3	2	9800-012	CERAMIC WIRE GUIDE
2	2	1004-200	#4 UNIBODY HOUSING
1	28	9004-201	3/8-16 X 1-1/2 HEX HEAD 12 PT SCREW

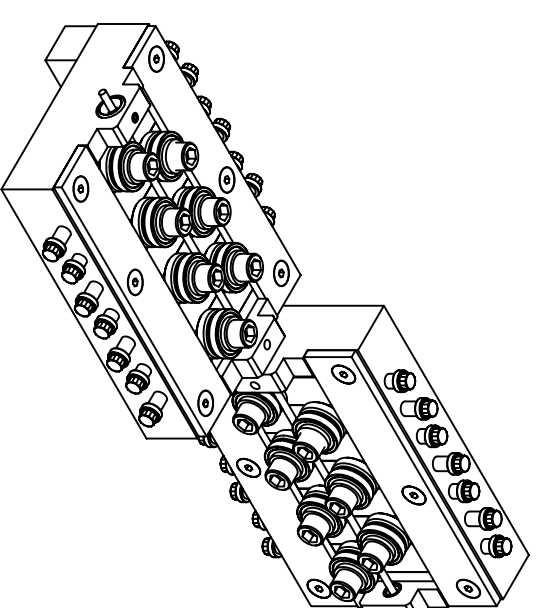

REV	ECN	CHG BY	DATE



TOLERANCE UNLESS OTHERWISE STATED		CAD	DRAWING / PART NO.
∅ ± .0003	FRACT +/- 1/16	DWN	1004-012
∅ ± .0002	X	RPL	PART NAME
∅ ± .0005	XX ± .015	CHK	#4 PWS ASSY.
∅ ± .0005	XXX ± .005	SCALE	CUSTOMER
∅ ± .0005	XXXX ± .0005	DATE	EXPLODED VIEW