

STAMP JOB # FROM TRAVELER
IN AREA UNDER ADJUSTMENT
SCREWS AND CENTERED

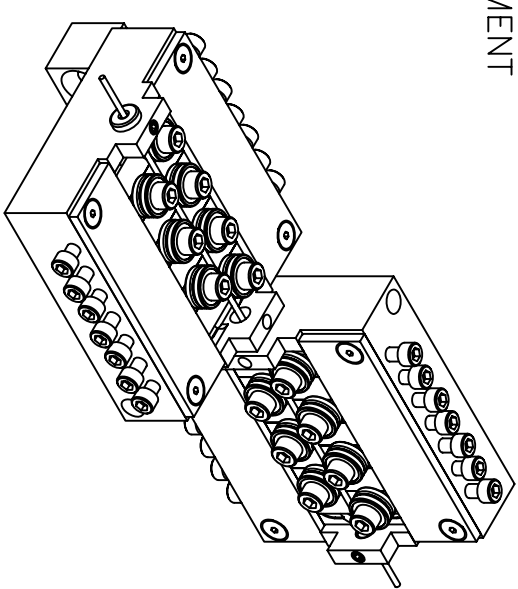

ITEM	QTY	PART NUMBER	DESCRIPTION
14	4	9001-123	5/16-18 X 1-3/4 FHCS
13	1	1003-177	ALL BANK CONNECTOR
12	2	9805-002	NAMEPLATE
11	1	1300-003	SLIP TORQUE KNOB ASSY. N/S
10	12	9001-074	10-32 X 1/2 FHCS
9	4	1003-112	ROLL CAP
8	14	9000-090	1/4-20 X 3/4 SHCS
7	14	9303-171	BEARING "V" GROOVE
6	14	9008-110	.250 ID X .375 OD SHIM WASHER
5	14	1003-130	ROLL PLATE
4	2	9003-407	8-32 X 3/16 SHSS NYLON TIP
3	2	9800-005	.140 ID CERAMIC WIRE GUIDE
2	28	9000-110	1/4-28 X 1-1/4 SHCS ADJUSTMENT SCREW
1	2	1003-111	UNIVERSAL #3 HOUSING

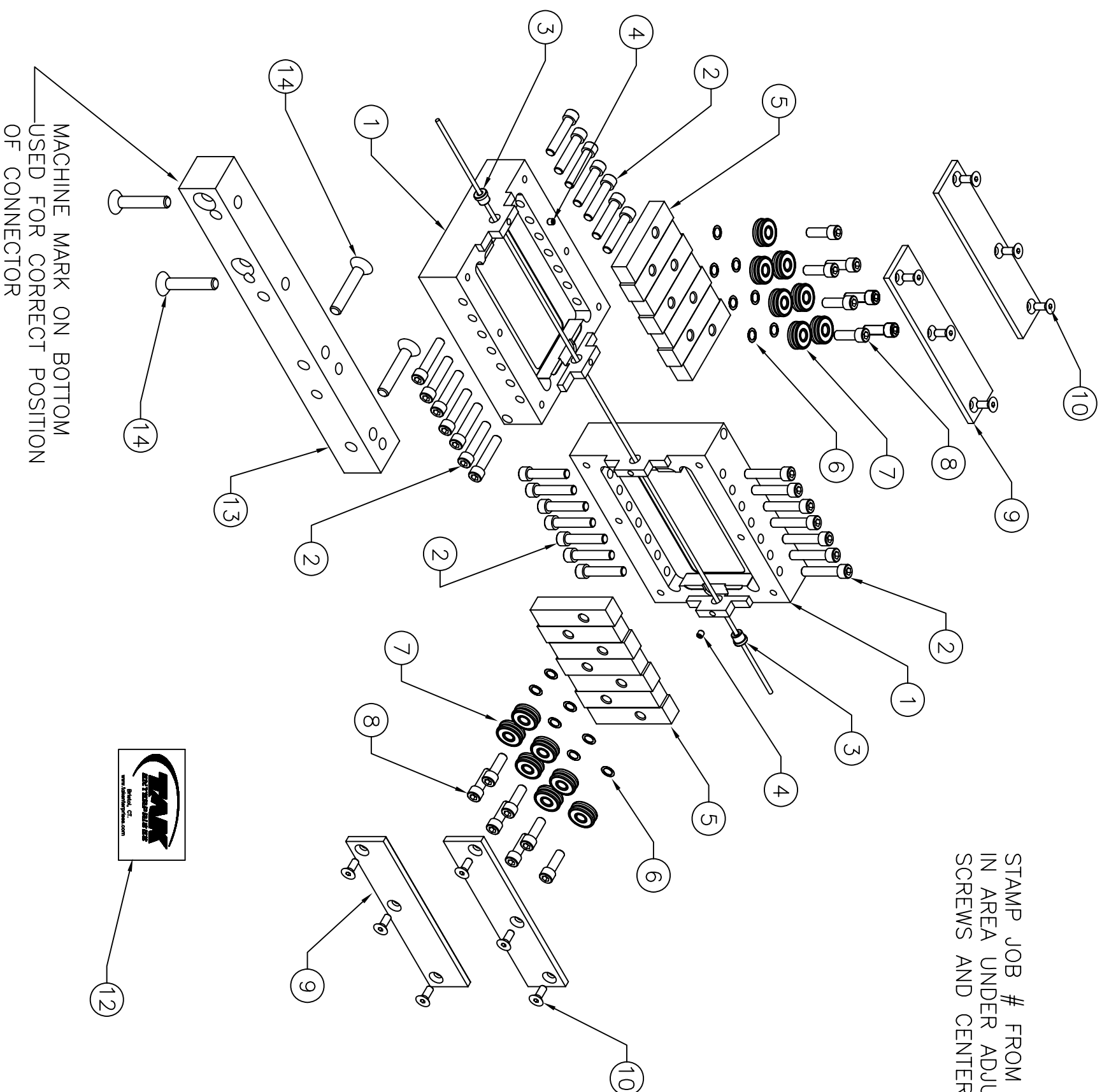

MACHINE MARK ON BOTTOM
USED FOR CORRECT POSITION
OF CONNECTOR

TOLERANCE UNLESS OTHERWISE STATED		CAD	DRAWING / PART NO.
∅ ± .0005	FRACT +/- 1/16	DWN	1003-002
∅ ± .0003	X	KPL	PART NAME
∅ ± .0002	XX ± .032	CHK	1003 2 PLANE
∅ ± .0005	XXX ± .015	SCALE	EXPLODED ASSY
∅ ± .0005	XXXX ± .005	DATE	CUSTOMER
		4/2/02	



REV	ECN	CHG BY	DATE